

LASER[®]

Part No. 2246

Diesel Engine Timing & Locking Tool Kit



 **MADE IN SHEFFIELD**



www.lasertools.co.uk

Guarantee



Distributed by The Tool Connection Ltd
Kington Road, Southam, Warwickshire CV47 0DR
T +44 (0) 1926 815000 F +44 (0) 1926 815888
info@toolconnection.co.uk www.toolconnection.co.uk

If this product fails through faulty materials or workmanship, contact our service department direct on: **+44 (0) 1926 818186**. Normal wear and tear are excluded as are consumable items and abuse.

www.lasertools.co.uk

www.lasertools.co.uk

Plan Layout

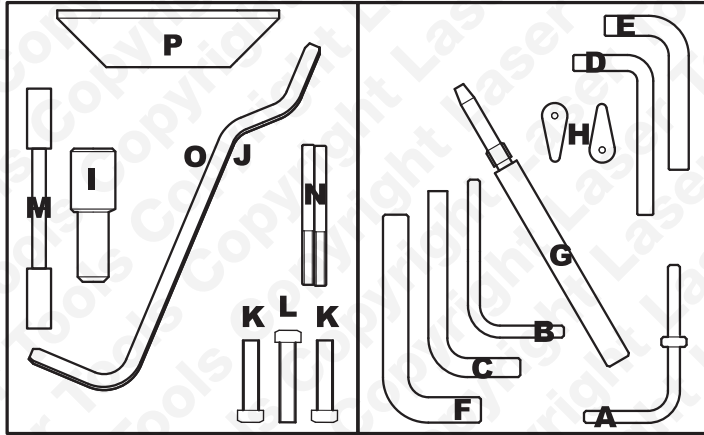

Ref	Code	OEM Ref	Description
A	C050	23-019	6mm Setting Pin + Washer
B	C051	0178B	6mm Setting Pin
C	C052	0178C/D 9767.94 0153M	8mm Setting Pin
D	C053	21-123 KM 6011 5711-TB	9.5mm Setting Pin
E	C054	0178A	10mm Setting Pin
F	C055	23-020	12.7mm Setting Pin
G	C060	21-104	TDC Setting Screw
H	C059		Shims (2)
I	C061	23-047 U20003 2064 5193 15-046	Setting Spigot
J	C062	7014-TJ 1 860 863 000 8mm 0188D	Cranked Setting Pin 8mm
K	C063	M8 x 35mm	M8 x 35mm Setting Screw (2)*
L	C064	M8 x 40mm	M8 x 40mm Locking Screw*
M	C086	LRT 12-058	Camshaft/Crankshaft Locking Pin (2)*
N	C087	18G 1549	Injection Pump Locking Pin M6 (2*)
O	C088	18G 1632	Cranked Setting Pin 6mm
P	C188	2065A	Setting Bracket

Warning

Incorrect or out of phase engine timing can result in damage to the valves. The Tool Connection cannot be held responsible for any damage caused by using these tools in anyway.

Safety Precautions – Please read

- Disconnect the battery earth leads (check radio code is available)
- Remove spark or glow plugs to make the engine turn easier
- Do not use cleaning fluids on belts, sprockets or rollers
- Always make a note of the route of the auxiliary drive belt before removal
- Turn the engine in the normal direction (clockwise unless stated otherwise)
- Do not turn the camshaft, crankshaft or diesel injection pump once the timing chain has been removed (unless specifically stated)
- Do not use the timing chain to lock the engine when slackening or tightening crankshaft pulley bolts
- Do not turn the crankshaft or camshaft when the timing belt/chain has been removed
- Mark the direction of the chain before removing
- It is always recommended to turn the engine slowly, by hand and to re-check the camshaft and crankshaft timing positions.
- Crankshafts and Camshafts may only be turned with the chain drive mechanism fully installed.
- Do not turn crankshaft via camshaft or other gears
- Check the diesel injection pump timing after replacing the chain
- Observe all tightening torques
- Always refer to the vehicle manufacturer's service manual or a suitable proprietary instruction book
- Incorrect or out of phase engine timing can result in damage to the valves